



2024 BPG ANNUAL EXHIBITION PACKAGE CALL FOR ENTRIES

Borderlands Gallery, Booth Museum · Cartersville, Georgia
Exhibition Dates: August 12 – November 10, 2024
Deadline to Enter: May 5, 2024

ALL BOOTH PHOTOGRAPHY GUILD MEMBERS ARE INVITED TO ENTER THE 14TH ANNUAL JURIED EXHIBITION.

- Members may submit up to 5 (five) jpeg images between 5MB and 10MB each for a single entry fee of \$35.
- There is no theme for the Exhibition.
- Entering does not guarantee a participant will have an image selected.
- Two judges who are not BPG members will anonymously jury and judge the images.
- The judges may select two images maximum per member. On the Entry Form, members may indicate if they want the jurors to select only one image for the Exhibition.
- Ribbons and cash prizes based on total entry fees will be awarded at the Awards Ceremony.
- Images juried into the Exhibition must be framed following the museum-quality standards defined in **Specifications for Printing, Matting, and Framing** (pages 3-4).
- Exhibited images may be offered for sale by the member. A price list, including contact information, will be available in the gallery for the public. Sale transactions are conducted between the member and the purchaser and are not handled through the Booth Museum; no commissions are levied.
- If juried into the Exhibition, the member will provide a short writeup (up to 250 words) about each photograph for the catalog noting the inspiration for the photo, where it was taken, and any other words of wisdom to share.
- **[NEW] All framed images delivered to the Booth Museum must have the owner sign off that they approve the quality of the print and frame. If someone else delivers your framed images, you must email Marion Hudson (marionh@boothmuseum.org) at the Booth Library to inform her that you have approved the delivery of your image(s) and that you approve the quality of the print and frame. Framed images cannot be removed from the Exhibition wall before the advertised November 13 pick-up date.**

ELIGIBILITY

- Must be a current Booth Photography Guild member for the duration of the Exhibition.
- Image enhancements and composites are acceptable, including the use of filters, borders, textures, etc. However, images must begin with a foundational photograph by the member. All objects in the composite must be an original photographic work of the member. All editing of images must be done by the photographer.
- Foundational images and all composite elements must have been taken in the last 5 years (after Jan. 1, 2019).

- **[New] A.I. Created Images Are Not Permitted.** All entries must be created by the photographer using a camera. For composite pieces, each visual within the compilation must have been taken by the photographer with a camera. Additionally, images altered through the use of voice or text prompts, including uses of AI “Generative Fill,” are not allowed. Content Aware is allowed.
- Images previously displayed in the Cartersville Downtown Gallery **are eligible** for submission to the Annual Exhibition in the Borderlands Gallery of the Booth Museum.
- Images that have previously been displayed in the Booth Museum **are not eligible**. However, any images submitted for jurying into a previous BPG Annual Exhibition **but not juried in** may be resubmitted for jurying in the BPG 2024 Annual Exhibition.
- All content of submitted images must be of good taste. Nudity in images is not permitted.

2024 BPG ANNUAL EXHIBITION – KEY DATES

| | |
|---|--|
| Call for Entries | March 1, 2024 |
| Digital Entry Form & Fee Submission Deadline | Sunday, May 5, 2024 (Midnight) |
| Notification of Results of Jurying (via email) | By Saturday, June 1, 2024 |
| Delivery of Framed Images to Booth Museum | July 23 - August 2, 2024 |
| Exhibition Hanging | Monday, August 12, 2024 |
| Exhibition Dates | August 12 - November 10, 2024 |
| Reception and Awards Ceremony | Saturday, August 17, 2024 (2:00-5:00) |
| Image Pickup | November 13-22, 2024 |



2024 BPG ANNUAL EXHIBITION PACKAGE

INSTRUCTIONS FOR SUBMITTING DIGITAL IMAGES

Deadline: May 5, 2024

IMAGE SUBMISSION REQUIREMENTS

- The BPG member must complete the **Digital Entry Form** with digital image files attached by **midnight May 5, 2024**.
- \$35 entry fee submitted payable to the Booth Museum for up to 5 images.

INSTRUCTIONS FOR SUBMITTING DIGITAL IMAGES AND FEE

- Access the **Digital Entry Form** on the BPG website or [CLICK HERE](#)
- READ INSTRUCTIONS CAREFULLY. SINCE IT IS ELECTRONIC, YOU CANNOT MAKE CHANGES ONCE SUBMITTED.

- Name each image file using the following naming convention:

Name (LastFirst)_**Title** (no spaces)_**image number** (for each image 1 - 5)

Example: **DoeJane_FullMoon_1**

The image title cannot be changed once submitted on the Entry Form.

- You will need TWO versions of your digital image file:

- 1) high resolution file for your Exhibition print. Depending on the size of the print, this typically requires a minimum file size of 12MB at 300ppi. (Example: 16x20 at 300ppi is approx. 12MB file)
- 2) low resolution jpeg file for jurying: 5MB to 10MB

NOTE: When saving your downsized digital images for submission/jurying, be sure to select "SAVE AS" which will create a duplicate file. DO NOT select "SAVE." If you select "SAVE," you will replace the higher quality photographic image with a smaller file that will not be of adequate print quality to show in the Exhibit.

- After successfully submitting your Digital Entry Form and digital images, you will immediately receive a confirmation email. If this automated response is not received, it is your responsibility to confirm that the chairman received your submissions before the May 5th midnight deadline. (exhibit@boothphotographyguild.org)
- Entry fee of \$35 may be submitted one of four ways:
 - Make an online payment at [CLICK HERE](#)
 - Hand deliver a check or credit card to Booth Museum staff at front desk.
 - Call in your credit card to Museum 770-387-1300
 - Mail a check payable to "Booth Museum" postmarked by **May 5th** to:
BPG Fall Exhibition, Attn Marion Hudson, PO Box 3070, Cartersville, GA, 30120

NOTIFICATION OF JURORS' SELECTED PHOTOGRAPHIC IMAGE(S)

Results of jurying will be emailed to you by June 1, 2024. Entrants with accepted images will be sent the **Delivery of Framed Work** form to accompany framed pieces when delivering them to the museum.

QUESTIONS? Please contact Michael Rogers, 2024 BPG Exhibition Chairperson, at: exhibit@boothphotographyguild.org



2024 BPG ANNUAL EXHIBITION PACKAGE SPECIFICATIONS FOR PRINTING, MATTING & FRAMING

The specifications below are designed to ensure a uniform and professional appearance for the Museum Exhibition. Members whose framed images are not in compliance will be **notified to make adjustments**. **Therefore, it is advisable to deliver framed pieces earlier than the July 23-Aug 2 deadline.**

Specifications for Presentation of Images

- “Photographic Image” is made up of pixels captured by the camera.
- The photographic image must be a minimum of **320 square inches** (length x height)
NOTE: The dimensions of the print, mat or frame are not relevant for making this calculation.
- “Print” refers to the paper the photographic image is printed on, which is typically larger than the photographic image.
- All varieties of photographic papers, including fine art papers, and deckled papers are acceptable.

Specifications for Matting (see diagram on page 4)

- Mats are required on all prints and must measure a minimum of **3 INCHES OF VISIBLE width**.
- The only acceptable mat colors are white or off white (no cream or beige)
- The mat must either have a core bevel that is white, off white or black.
- Triple matting is acceptable.
- The accent mat reveal must be white, off white, or black. Black accent reveal must not exceed 1/4”.

Specifications for Framing (see diagram on page 4)

- Actual frame width must be 2” or wider.
- Maximum OUTSIDE width of completed framed piece cannot exceed 40”.
- Maximum OUTSIDE height of completed framed piece cannot exceed 48”.
Note: Retailer frame packaging dimensions refer to the INSIDE of the frame opening rather than the outside frame dimensions.
- Glass or acrylic are required.
- Only solid-colored black frames made of wood or composite material are acceptable (no metal).
- Frames must have D-ring hangers 3/8” or larger attached to each side of the back of the frame.
- D-ring hangers should be positioned 1/4 of the total height down from the top of the frame.
- Hanging wire is optional.



Framing & Matting Specifications

You may want to provide this checklist to your framer when placing your order.

Photographic Image - Check List

This refers to the photograph image and does not refer to the print (paper) dimensions.

Size Minimum: 320 square inches (length x height)

Size Maximum: Must fall within frame dimensions/specifications.

- A - Frame:** 2" minimum moulding width. **Solid black in color.** Wood or composite (no metal). Glass or acrylic required.
- B - Outside Frame Width:** 40" maximum
- C - Outside Frame Length:** 48" maximum
- D - Mat:** 3" minimum **VISIBLE** mat width. Frame overhang (rabbet width) is not included in the 3"
- E - Mat Core Bevel** in black, white or off white
- F - Accent Mats** are optional. Accent mats must be in white, off white, or black. Black accent mat reveal must not exceed 1/4".
- G - Floating Image Presentation** refers to presentations where the print (paper) trims smaller than the mat opening, and appears raised or floating, and reveals white or off white, backboard.
- H - D-Rings** On back, position D-rings 1/4 the distance from the top of the frame. No wire is needed.

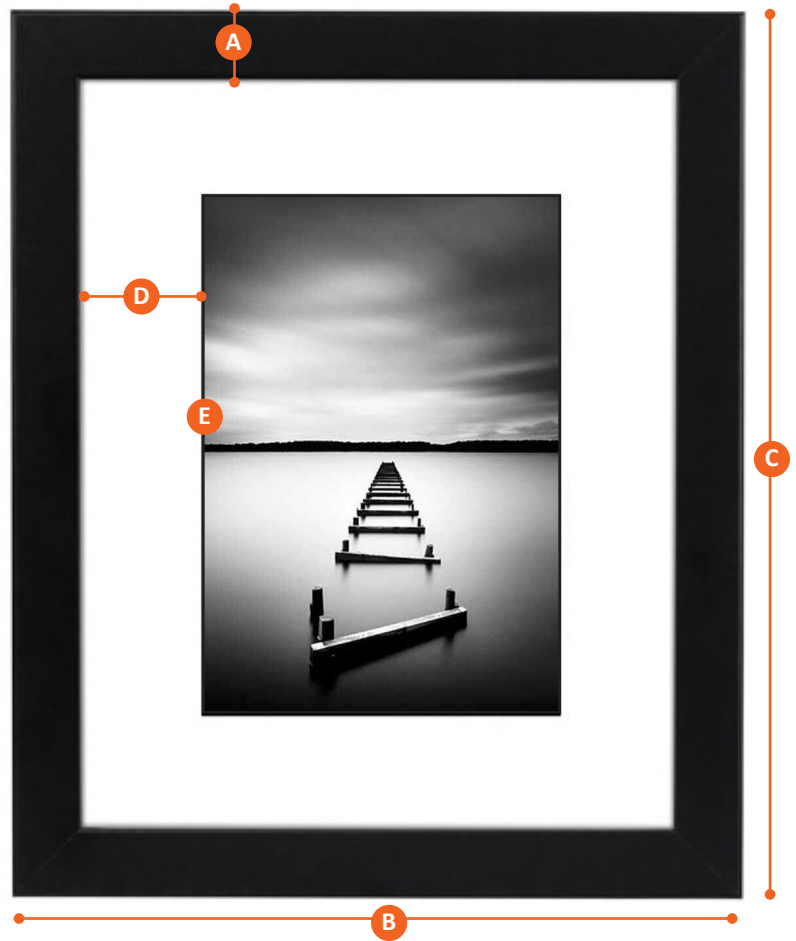

Single White Mat with Black Core Bevel



Double Mat. Accent Mat Is Black (optional)



Double Mat (optional) Floating Image (optional)

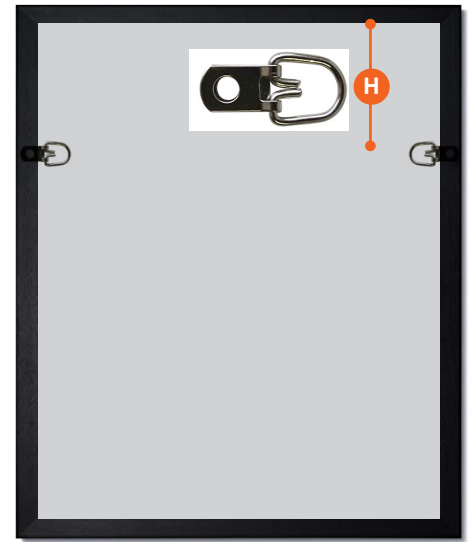

Back D-Ring Placement (no wire needed)